

2

1

B

B

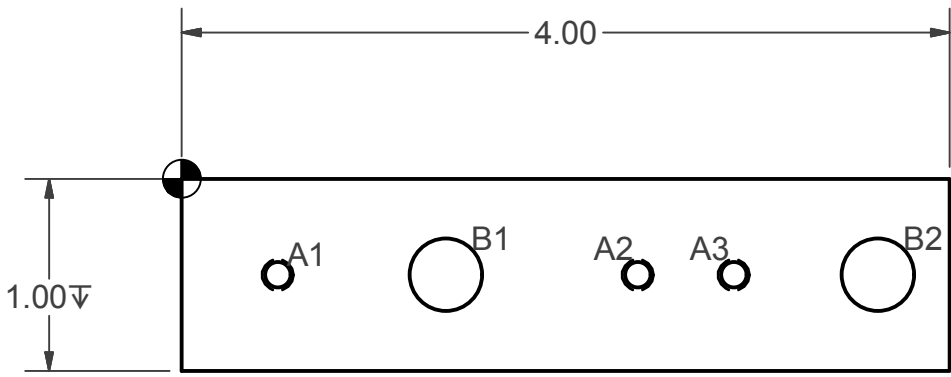

Mark with Part Number  
L17\_TSI\_004

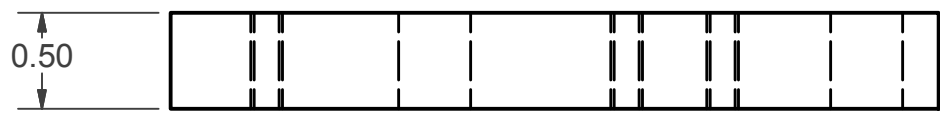

A

A

| Hole Table |      |       |               |
|------------|------|-------|---------------|
| HOLE       | XDIM | YDIM  | DESCRIPTION   |
| B1         | 1.38 | -0.50 | Ø0.38 THRU    |
| B2         | 3.63 | -0.50 | Ø0.38 THRU    |
| A1         | 0.50 | -0.50 | 8-32 UNC - 2B |
| A2         | 2.38 | -0.50 | 8-32 UNC - 2B |
| A3         | 2.88 | -0.50 | 8-32 UNC - 2B |

Designer: Christer Hoeflinger  
 System Eng: \_\_\_\_\_  
 ECE: \_\_\_\_\_  
 ME: \_\_\_\_\_  
 Email: hoeflinc@lafayette.edu

A

A

|   |  |  |                       |                               |
|---|--|--|-----------------------|-------------------------------|
| LAFAYETTE COLLEGE<br>ENGINEERING DIVISION                                 | TSV- Bar                                       |  | DWG.#: L17_TSI_004_D1 | REV: 1                        |
|   | PART #: L17_TSI_004                            |  | QTY: 1                | DRAWN BY: Christer Hoeflinger |
| TOLERANCE EXCEPT AS NOTED<br>X/X .X .XX .XXX<br>± 1/32 ± .02 ± .01 ± .005 | PART FILE: TSV-Bar.ipt                         |  | Sheet 1/1             | Approved by:                  |
|   | MATERIAL: Aluminum Bus Bar   McMaster: 8975K11 |  | SCALE: 1:1            |                               |
|   |  |  | DATE: 4/6/2017        |                               |

2

1

A